

The Crosspoint, Bishopsgate/ Liverpool Street London EC2



41,340 sq ft (3,840.6 sq m)

savills.co.uk

Location

The Crosspoint is superbly located opposite Liverpool Street station and within yards of the new Crossrail entrance.

The shopping and leisure facilities of Broadgate, Spitalfields and Shoreditch are all nearby.

Description

A new Rolfe Judd designed development of circa 40,000 sq ft of Grade A offices with ground floor retail space.

The scheme is due for completion in early 2017.

Specification

- Air conditioning
- Raised floors
- Metal tiled suspended ceilings
- City skyline views on the tower floors
- Bike spaces with showers and lockers

Accommodation

Floor	Area (sq ft)
8 th	1,658
7 th	4,706
6 th	4,752
5 th	4,752
4 th	4,752
3 rd	7,272
2 nd	7,269
1 st	5,315
Ground – reception	864
Total	41,340

Architects areas – to be measured on completion.

Viewing - strictly by appointment through:-

James Gillett
Savills
020 7409 8961
jgillett@savills.com

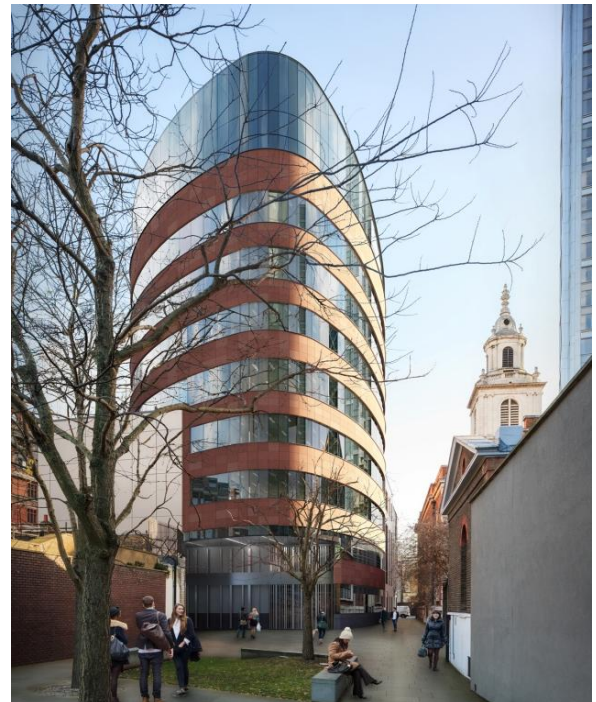

VAT

The building is elected for VAT

Lease

By arrangement

Quoting rent

Not Quoting

Rates

Guiding £22.50 per sq ft

Service Charge

Guiding £10.00 per sq ft

Floorplan – Typical Floor

2nd Floor

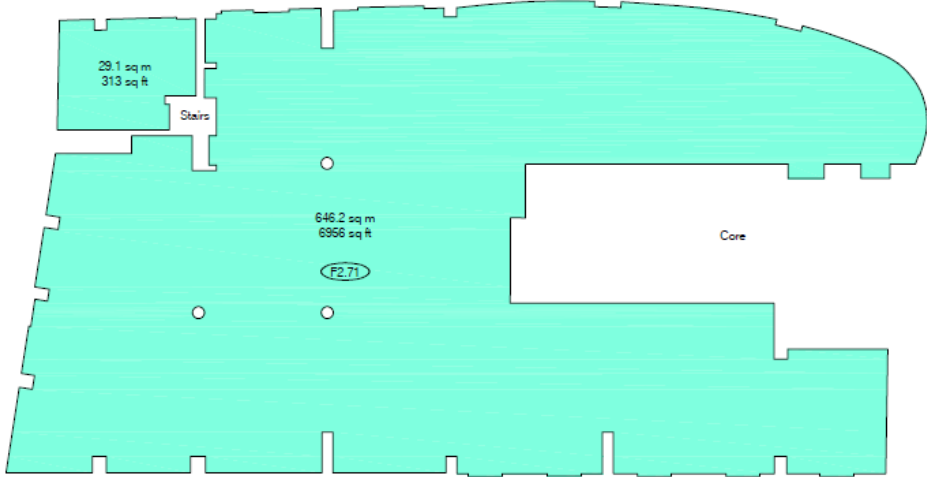

7th Floor

